

## DYERT E JASHTME TË REJA

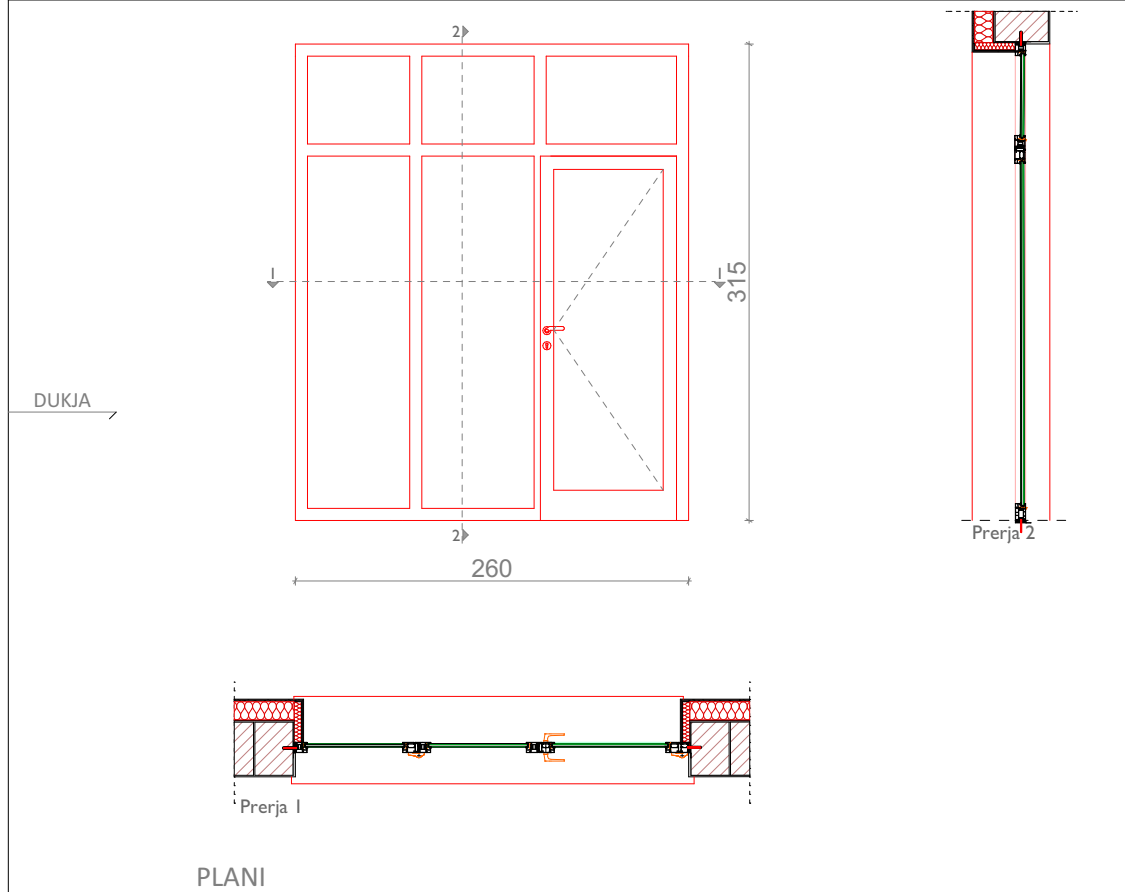



PLANI

### Pos. D-02

Specifikimi Teknik, Dimensionet, Standardet e kerkuara

Dimensionet: 260/ 315 cm	Ngjyra : Bardhe/ RAL 9003
Sasia : 1 copë	Standardet : DIN EN ISO 9001
Materiali : Alumin	Qelqi : 4(Katër Stinor)+16+4Low E
Korniza: Gjerësia≥85 mm	U-Value (dritare) : $U_w \leq 1.2 \text{ W/m}^2\text{K}$
Izolimi akustik : EN 14351, EN 717/ $R_w=42\text{dB}$	

Emri i Projektit: Consulting Company for Development of detailed energy audit reports, Detailed Designs, Technical Specification			Përpjesa 1:50	Nr.i vizatimit A.46	Vula
Financuar nga:  <b>FKEE</b> <small>FONDI I KOSOVES PER EFICIENCË TE ENERJESHE KOSOVO FUND FOR ENERGY EFFICIENCY KOSOVO ENERGY EFFICIENCY FUND</small>	Projekti kryesor Arkitektura	Vizatuar nga: B.B	Kontrolluar nga: Xh.G.		
Projektuar nga:  <b>ALB-Architect</b> <small>PROJEKTIM MENAXHIM I PROJEKTIT KONSULTIME TEKNIKE DESIGN PROJECT MANAGEMENT TECHNICAL CONSULTING</small>	Emri i objektit: SHFMU "Shkëndija"	Vendi: Suhareke	Data : Shkurt 2024		
	Titulli i vizatimit Skemat e dverve D-02	Formati i fletës: A4	Nënshkrimi		